

4. Reassemble diaphragm Retaining ring back onto chestpiece drum by turning clockwise until tight.

Cautionary Notes

1. Please avoid extreme heat, cold, solvent, or oil.
2. If sterilization is necessary, gas sterilize only.
3. Do not use this device for diagnosis or treatment of any health problem or disease.
4. Do not leave exposed to direct sunlight for prolonged period of time.
5. Do not immerse the Accumed ST-SR-001 Sprague in any liquid or subject to steam sterilization.
6. Binaurals and tubing can be wiped down with alcohol or mild soapy water.

Operating Instructions

1. Make sure the eartips are securely fastened onto the binaural.
2. Insert the binaural into your ears carefully.
3. Tap your finger on one of the diaphragms which is in the open position gently. If you tap the diaphragm which is in the close position, please rotate the head of the stethoscope 180° until it clicks into position, then you can hear the tap strongly and clearly.
4. To replace a diaphragm or change to a bell, grasp the retaining ring (with entire assembly) and turn it counter-clockwise to unscrew. Then attach the diaphragm or the bell to the chest piece drum by turning it clockwise until secure.

accumed

Sprague Rappaport Type Stethoscope

Model: **ST-SR-001**

Introduction

The Accumed ST-SR-001 Sprague Rappaport Type Stethoscope has two-sided chestpiece with twin-tube design efficiency detects heart sounds. The Accumed ST-SR-001 uses 5 different sized chestpieces to take the place of five different stethoscopes actually and to provide Accumed quality acoustics for adult, children and infant.

This device is intended for medical diagnostic purposes only. It can be used for listening to heart, lung and other body sounds as well as for normal auscultation. With such a wide range of uses you will find that you are always reaching for your Sprague Rappaport Type Stethoscope and will not need any other stethoscope.

Name/Function of Each Part

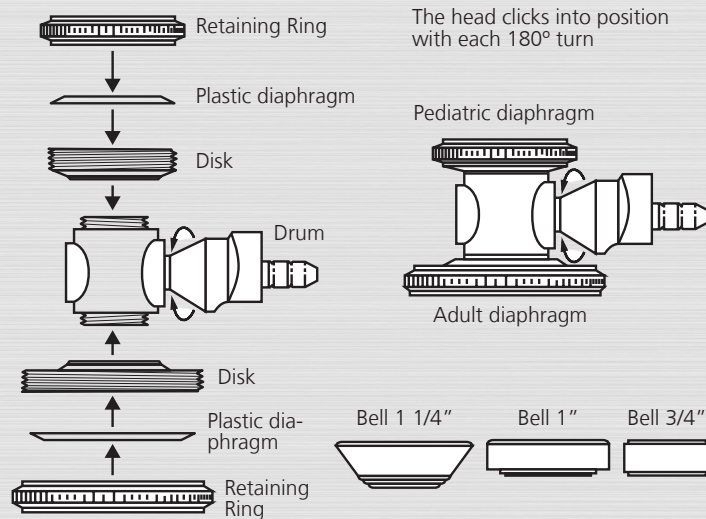

Name/Function of Each Part

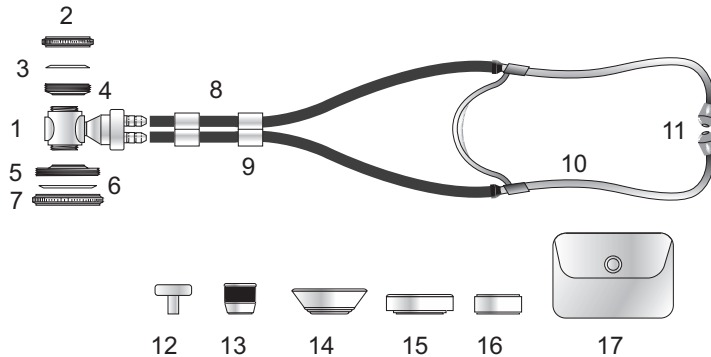

Ref. No.	Part Name	Qty	Ref. No.	Part Name	Qty
1	Chestpiece Drum Assembly	1	11	Eartips, Black	2
2	Retaining Ring, Ped.	1	12	Eartips, Black, Mushroom	2
3	Diaphragm, Ped.	1	13	Eartips, Clear, Soft	2
4	Aluminium Disk, Ped.	1	14	Bell, 1¼"	1
5	Aluminium Disk, Adult	1	15	Bell, 1"	1
6	Diaphragm, Adult	1	16	Bell, ¾"	1
7	Retaining Ring, Adult	1	17	Accessory Pouch	1
8	Tubing, 22" (spec. color)	3	3	Diaphragm, Ped. (spare)	1
9	Tubing Clip	2	6	Diaphragm, Adult (spare)	1
10	Binaural with Eartips	1			

Features

Threaded chestpiece drum of chrome plated zinc permits the use of five interchangeable chestpiece fittings - an adult and pediatric diaphragm, and three bells (1 1/4 inches, 1 inches, 3/4 inches) - for complete diagnostic capability in most patients.

Diaphragm

1. Adult diaphragm for filtering out lower frequencies and accent the higher ranges in adults.
2. Pediatric diaphragm for detecting high pitched murmurs in infants and children.

Bell

1. Adult size bell- for detecting low and medium pitched sounds and murmurs in adult.
2. Medium size bell-for detecting low and medium pitched sounds and murmurs in children.
3. Infant size bell- for detecting low and medium pitched sounds and murmurs in infants.
 - Convenient 22 inches tubing length.
 - Latex-free, double tube configuration.
 - Complete with an accessory pouch containing 3 bell chestpieces, 2 diaphragms, 2 pair of eartips and all in a vinyl storage case.
 - Adjustable chrome-plated brass binaurals.

Chestpiece Selection

On the Accumed ST-SR-001 Sprague, the entire chestpiece rotates 180° to permit selecting one side.



Note: Only one side is operable at one time.

To selection the operation side, hole the chestpiece stem and rotate it until a click is felt and heard.



Replacing the Diaphragm

1. Remove the desired assemble by gripping the assembly firmly and turning counter clockwise.
2. To loosen the diaphragm Retaining ring, remove worn diaphragm and replace with new.
3. Reassemble disk, tighten by turning clockwise until tight.